



ART RACE

"The organisation of light and shadows effects produce a new enrichment of vision" - Lazlo Moholy Nagy-

When we talk about light as information, we think about how light is invisible until it strikes something, that is when it manifest itself. Light reveals multiple layers of information in the course of its passage. What if light was our Medium?

CONCEPT. Decode, deconstruct, desematizize the LIGHT CONDITION of the room through PROPORTION and LIGHT ITSELF. We thereby recreate Oberlichtsaal geometry and proportion to trace the light journey along the walls of the original gallery. The light reflection inspired the structure and exhibition form. It is a building typology referring mainly to the light source of the space. The quality of the light and its effect on the space form the core of the concept.

THE BAUHAUS CONNECTION. This 100th anniversary of the Bauhaus, come home to where it all began and where the threshold for a new Bauhaus now begins. One of the earliest Bauhaus exhibitions first employed postcards as a means to invite people and spread words about the event. For one thing, postcards are essentially industrialized pieces of art. They were cheap to produce, could be made in bulk, and didn't require envelopes. "The medium was an important part of the message", Kitchin says. " Modern design at Bauhaus was not about creating one-off monumental or exclusive creations." Therefore the Bauhaus may be seen as one of the earliest paradigms of the Medium as a Message.

MEDIA, CONCEPT. The visitor and the Oberlichtsaal become one in this scintillating display of motion and light on geometry. The leap motion technology allows to project the visitors movements digitally at the inner geometry of the structure. The Leap Motion Controller shows the power of a simple technology. It is a small USB peripheral device, which converts the visitors' movements into 3D inout. Leap works using infrared optics and cameras sensors. It tracks the movement of hands and fingers with very low latency, converting in images for a new and unique user experience.

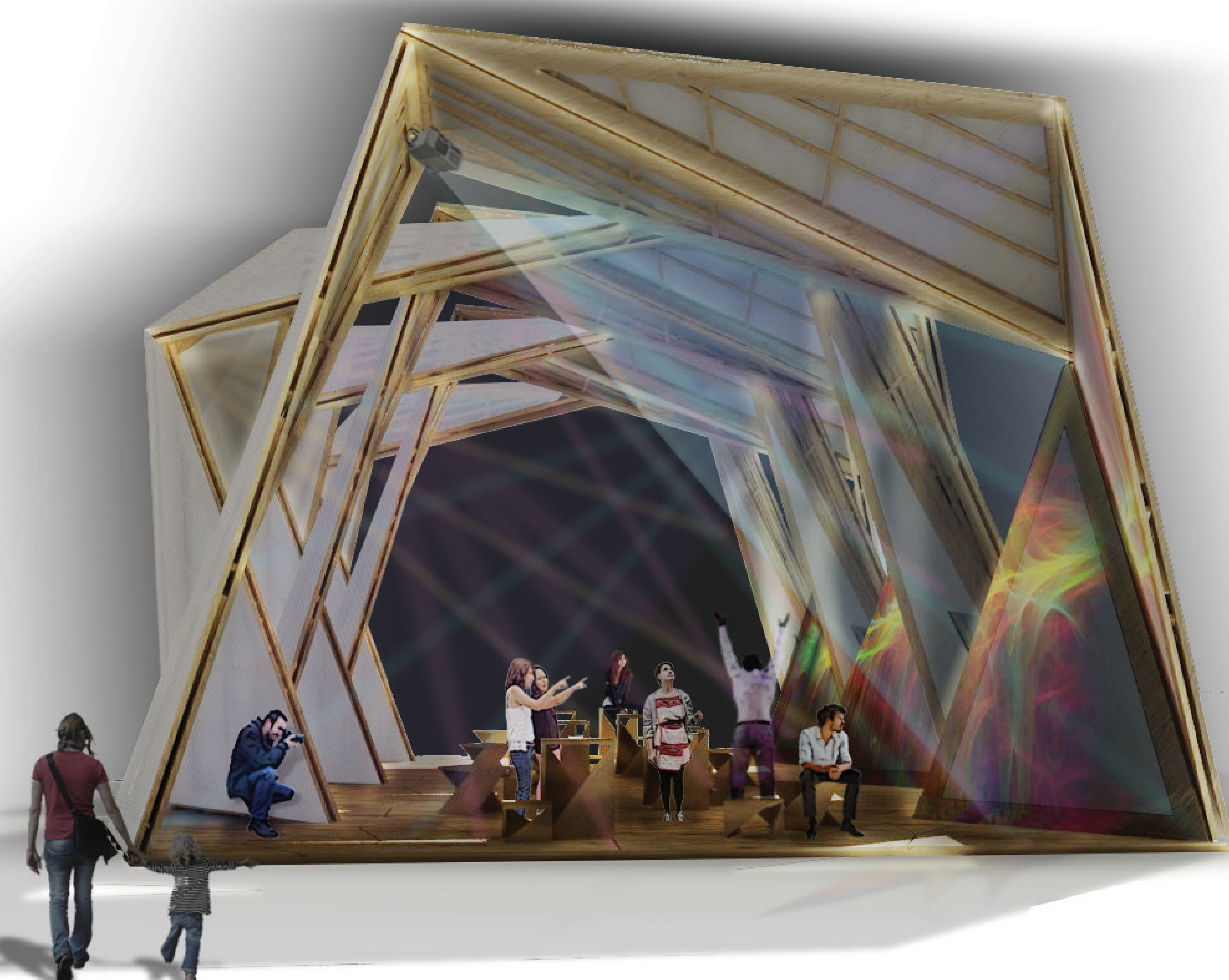
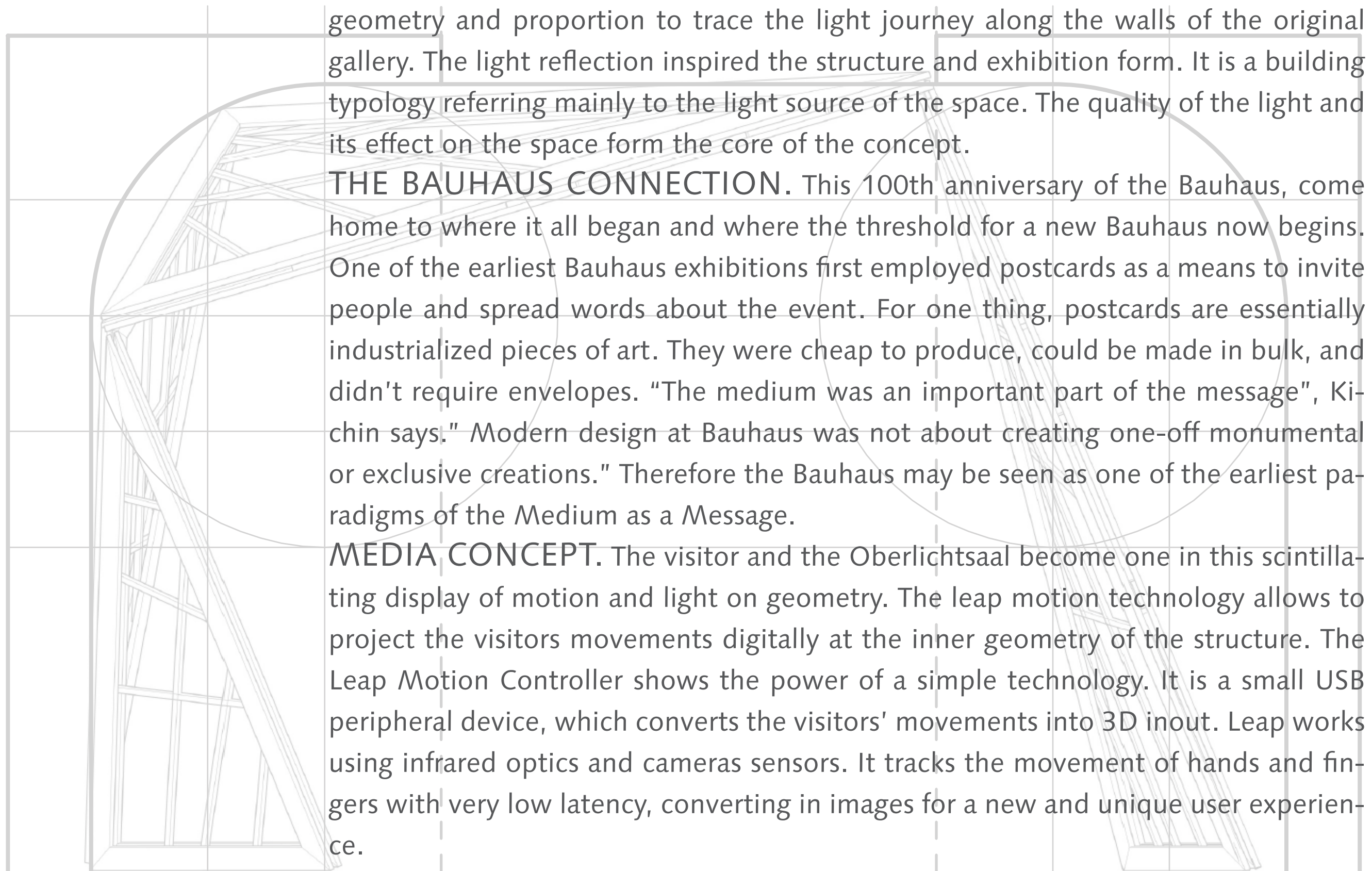
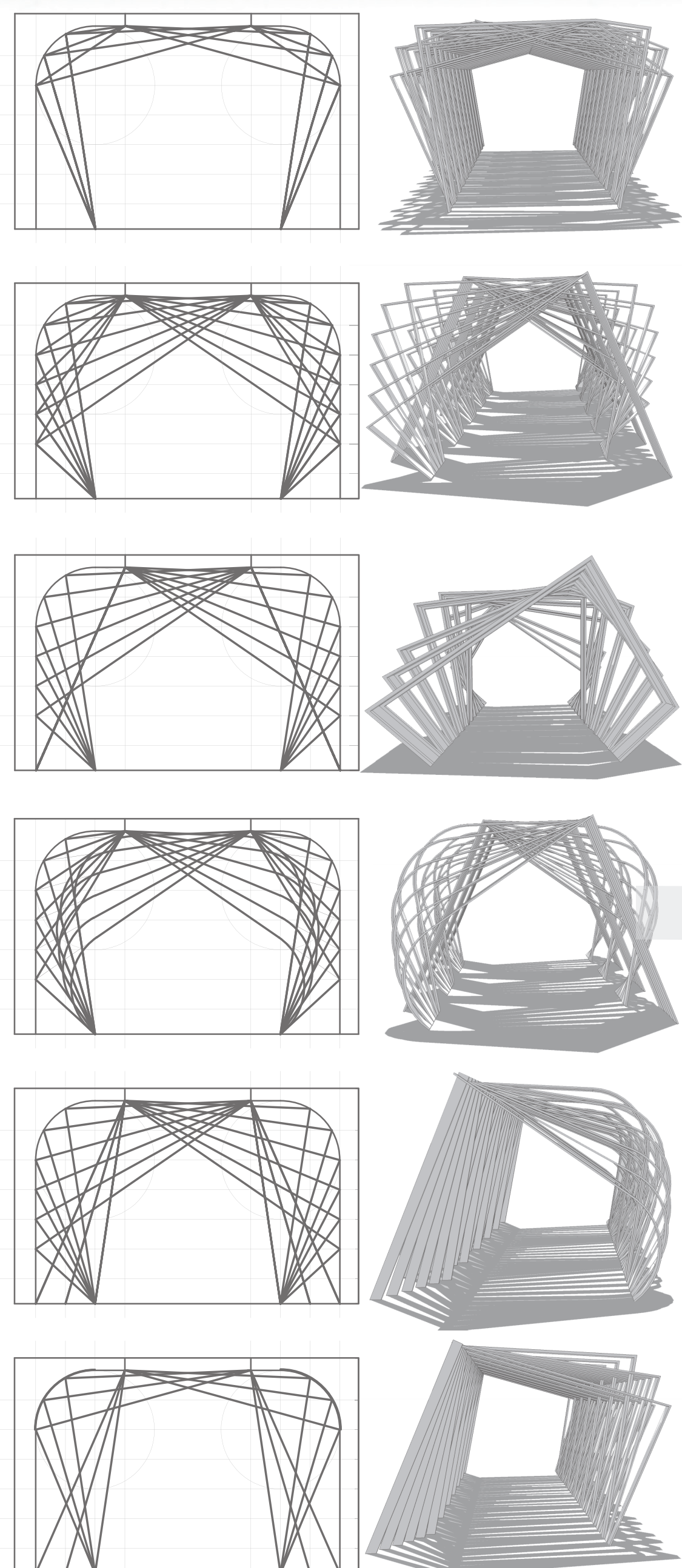

Night view - CREATE an interactive gathering space



Outside view - STRUCTURE details

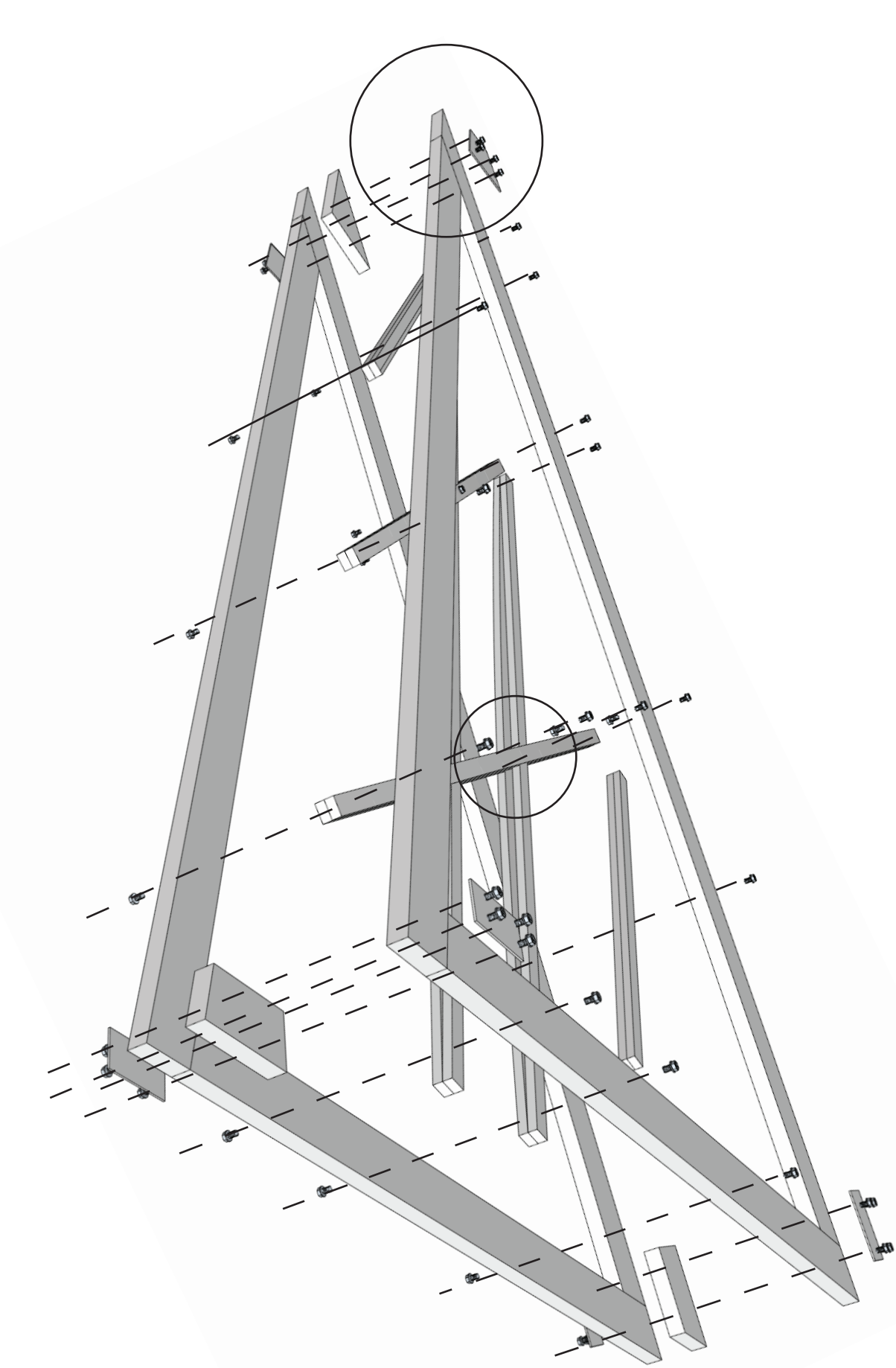

FRAMES ASSEMBLY PERSPECTIVE

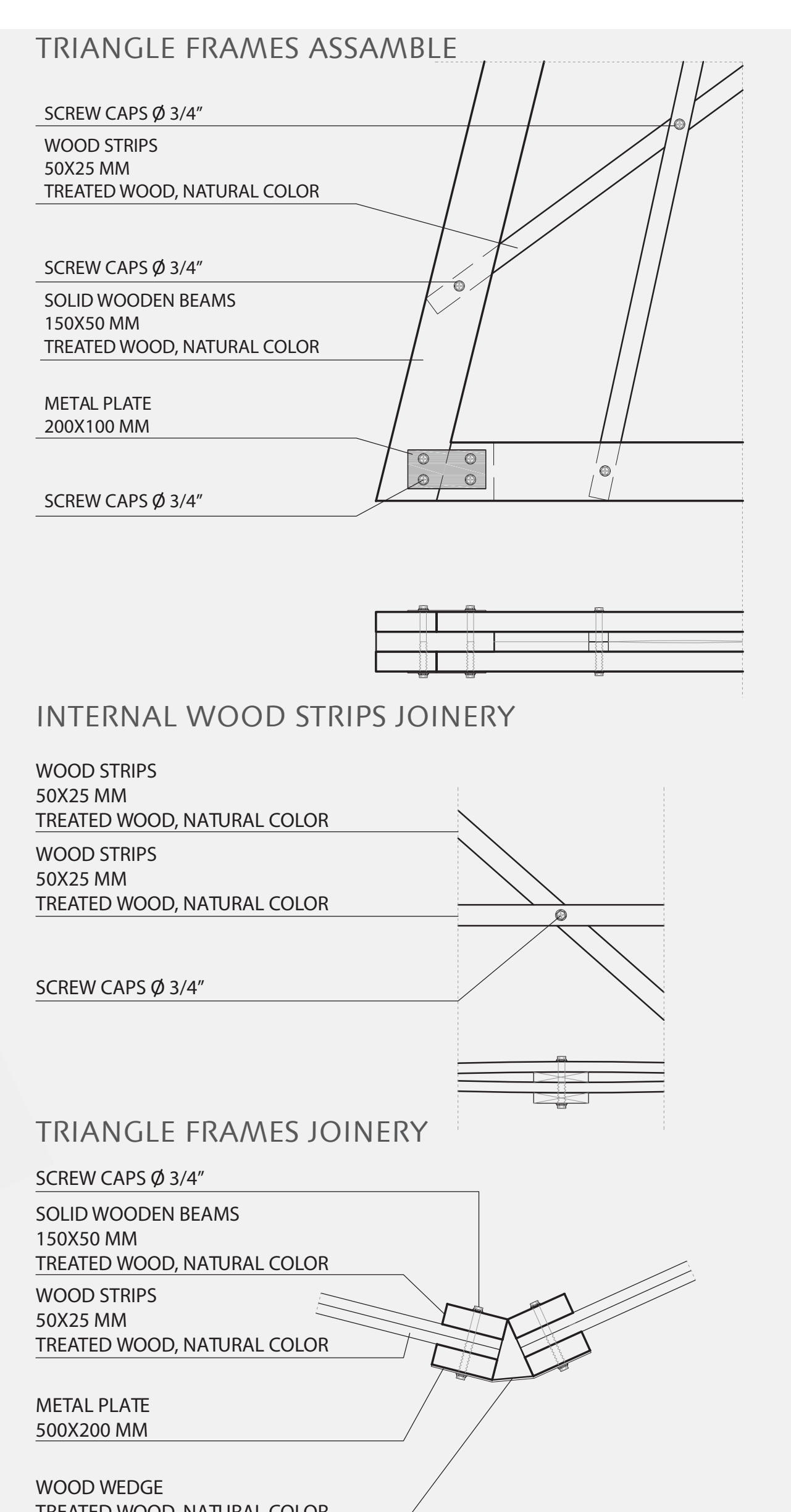

Projektmodul Wintersemester 2015/16

Lea Brugnoli
Ulysse Fontaine
Dechang Fu
Hala Ghatasheh
Maria José Landeta
Asha Nariyambut Murali

Professuren
Bauformenlehre
Darstellungsmethodik
Tragwerkslehre

Betreuung
Prof. Dipl.-Ing. Dipl. Des. Bernd Käßner
Prof. Dr.-Ing. Jürgen Ruth
Dr.-Ing. Dipl.-Ing. Sabine Zierold

Gastkritik
Junior-Prof. Dr.-Ing. Reinhard Koenig

MediaArchitecture